



## The Annual Report of the West Wycombe Parish Council 2009/10

This publication is based upon the report given by Cllr. Mrs J Smith, Chairman of the West Wycombe Parish Council at the Annual Parish Meeting on 29th April 2010. Further reports from West Wycombe Community Association, The National Trust, West Wycombe Combined School, West Wycombe Community Library, West Wycombe Pre-School, West Wycombe Estate and The Parochial Church Council can be found on our website [www.westwycombe.org.uk](http://www.westwycombe.org.uk)

### Pedestal Playing Field

Signing a lease from West Wycombe Estate for the Pedestal Playing Field has enabled us to gain control of the only fields or open spaces for lease or sale in the Parish. This puts us on the first rung of the ladder in providing a much requested children's play ground.

Hithercroft Football Club have played on the site for many years and we are very happy that they should continue playing there. We have put in new fencing and gates, tidied up the hedges, surveyed the trees and obtained three quotes for play equipment and grass cutting.

We have been saving for play equipment for the past two years and are working on a budget of £40,000 spread over three years. We hope to have some equipment on the playing field this Summer.

Play equipment is costly and whilst we have put some money aside for this, it will not go very far and we do want to have good range of equipment for the children. So, to this end, we have decided to try and involve

the whole community by organising a fete later this year to raise awareness of the playing field and to help us collectively raise money for it.

We have had good support already from a few of our local organisations who want to come along and share the day with us to raise money for themselves as well as for the playground but we need more and lots of help on the day.

Our website will be continually updated with the latest information and details of who's taking part.

Please contact a Parish Councillor or the Clerk, either through the website or using the contact information on the back page of this publication.

We will be pleased to hear from you if you can help in any way to help us create this facility for our children and grand-children.

If you're not able to help please come along on the day.

**NEW PLAYGROUND AND FUND RAISING FETE**  
see centre pages

### **Allotments**

Last year we started to lease land in Chorley Road from West Wycombe Estate. This had been allotments some years ago but had not been used for a long time.

We virtually had to start from scratch to get the land into working order but as we had a good few requests from residents for allotments we were pretty sure we would not be spending money unnecessarily.

We were able to create 20 allotments which have all been taken and we are very pleased to see the way our allotment holders have worked on their plots and we plan to have an official opening this coming season.

We offered an allotment to West Wycombe School so the children could get a feel for gardening and producing their own vegetables.

We have had the hedges cut around the allotment field and some hard standing put inside the gate so that those bringing in fertiliser and tools by car can now get off the highway.

A notice board has been erected and all the allotment holders have a copy of the rules and regulations so that there can be no misunderstandings.

We would like the tenants to organise their own allotment committee.

### **What's the Precept?**

This is a question we're often asked.

The precept is the money we ask Wycombe District Council for each year to run the Parish Council and you find detailed on your Wycombe District Council Tax statement.

Parish Councils are not capped with the amount they can ask for but we always want to give good value for the money you entrust us with.

We start planning the next year's budget in November and our precept request has to be in by the beginning of January. We then receive one half of the precept in April and the other in October.

We have kept our precept at the same level as last year in the light of the financial recession but of course it means we cannot do all the work we would like to.

---

### **Transport For Bucks**

Need a hole filling in the road, street light not working, road sign broken, tree or hedge over-hanging the pavement?

Telephone  
**0845-230 2882**

or you can log-on to the website and report your problem online at:

**[www.buckscc.gov.uk/tfb](http://www.buckscc.gov.uk/tfb)**

### **COUNCILLOR VACANCY**

West Wycombe Parish Councillor has a vacancy for a Councillor.  
Please contact the Clerk or any Councillor for an informal chat.  
You can learn more about what's involved by visiting our website at  
[www.westwycombe.org.uk/roleofaparishcouncillor.html](http://www.westwycombe.org.uk/roleofaparishcouncillor.html)

### **Ongoing.....**

Our roads and pavements were very much affected by the weather this winter, as they were all over the High Wycombe area, so we have had talks with Bucks County Council (BCC) on managing the clearing of snow this year and in the future.

Our Burial Ground grass is just one area that has suffered through the harsh winter and has needed some extra attention.

We have liaised with BCC and the National Trust to try and work out a way to stop serious accidents at the High St/ Chorley Rd/Ness Cottage junction. There really is not an easy solution when in the end it comes down to bad driving.

Much of our time is taken up with planning applications and we look at them most carefully to make sure the new plans fit along side neighbouring properties well and keep within the law. We can only recommend our ideas to Wycombe District Council (WDC) and our local knowledge counts for a lot but sometimes the eventual decision is not what we hope for.

We have been asked to look into a pedestrian crossing on the Bradenham Road side of the Pedestal roundabout and whilst there seems to be no planning objections there is no money available for the £25,000 to £35,000 it will cost. It would put our precept up a huge amount if we were to pay for it ourselves.

We keep up to date and on top of the constantly changing ideas in all aspects of our council work by attending training seminars and reading the

many documents sent our way by the three tiers of government above us.

We attend all the meetings of the Wycombe Association of Local Councils (WDALC) where we can exchange views and ideas with councillors from other parish councils. This is always valuable.

We belong to WDC Rural Forum which gives us interesting and useful information about all aspects of our countryside.

We also belong to the Bucks Association of Local Councils (BALC). Our Chairman, is on the executive BALC which represents all the parish councils in Buckinghamshire.

Our Chairman is a member of WDC Standards Committee which governs Code of Conduct of councils and councillors and also our local Neighbourhood Action Group. (NAG). Which includes members from Lane End, Piddington and Wheeler End, Stokenchurch, Radnage and our local police team. We try and help each other sort out problems in our villages such as speeding and anti social behaviour.

We also attend BCC's Local Area Forums where there is small budget that Parish Councils can bid for help with their local projects. We have asked for money for 3 new street lights by West Wycombe School.

By attending and belonging to these associations we can see how other councils and councillors work which in turn helps us all to form ideas and make decisions based on knowledge we have picked up along the way.

## **Thank you**

We would like to thank the small group of residents who come to our meetings each month. We very much appreciate you coming out in all weathers. Our meetings are on the second Thursday of each month (except August) at 8 pm in the Church Room.

We would like to thank Mike Henson who looks after our website for us. [www.westwycombe.org.uk](http://www.westwycombe.org.uk) We have many compliments about our website and we wish more residents and local businesses would use it to advertise their existence and their activities.

We would also like to thank our two Wycombe District Councillors Jean Teesdale and Ian McEnnis for their support and hard work for our area. Our thanks to, to Frank Downes, our County Councillor who is also one of our Parish Councillors and keeps us informed of BCC news, especially that relevant to us.

Surrounded as we are by West Wycombe Estate and National Trust land and houses it is good for us to have Neil Harris, the National Trust's Gardens and Countryside Manager as an affiliated, but non voting, non elected member, of our Parish Council and we are grateful for his support.

We would like to thank Sir Edward Dashwood for leasing the land to us for the allotments and the playing field and to Cllr Roger Seymour and our Clerk, Sharon Henson for all the hard work they have put in to get them up and running. Sir Edward also supplies us with two Christmas trees each year which makes the Village, the centre of our parish, look very festive.

We were very proud to have achieved Quality Status accreditation in September 2005 but it only lasts for four years so we applied for re-accreditation in 2009 and are pleased announce we have fulfilled the strict criteria needed to be recognised again as a Quality Parish Council.

We are one of only two councils in the Wycombe District to have gained Quality Status and there are only 17 to have achieved this in the whole of Buckinghamshire.

Some of the things we had to provide in our portfolio for instance are: that our finances are accurate and transparent, that we have a qualified clerk, that our meetings are well run and that at least two thirds of our councillors have stood for election. In fact all our councillors stood for election last time round.

We have adopted the Code of Conduct and The Standard Terms and Conditions of employment and we regularly attend training sessions and we have to produce this Annual Report.

These are just a few of the things we had to prove to the judges at BCC and the Bucks Association of Local Councils to gain Quality Status.

Quality Councils have a greater say and control over their work and can take on some of the functions of the District and County Councils should they think it appropriate. Quality Status is a Government initiative.

The award was presented to us at our March Parish Council meeting by the Chairman of BALC, Mr Patrick Martin.



**PROPOSED PLANS FOR WEST WYCOMBE P**

The Parish Council has just placed the order for the first phase of play equipment for The Fete mer holidays. We agreed that the three year project would have a maximum budget of £40 spent several thousand pounds on repairing the fencing and having the trees maintained a height barrier which will allow parents to park in the playing field. The second phase will tal Ball Wall (far left on the plan) finishing the project in 2012.

**With your participation in helping us to raise money at the Fete**

We have already been promised £2000 from Sir Edward Dashwood and £500 from n

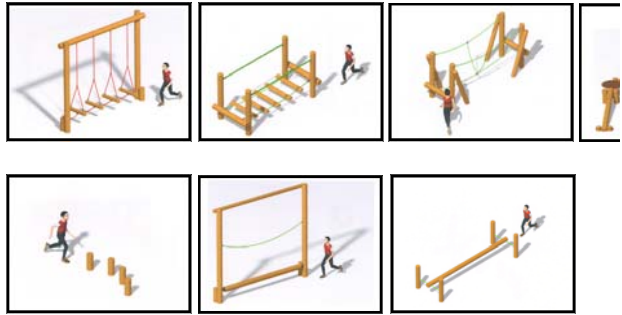
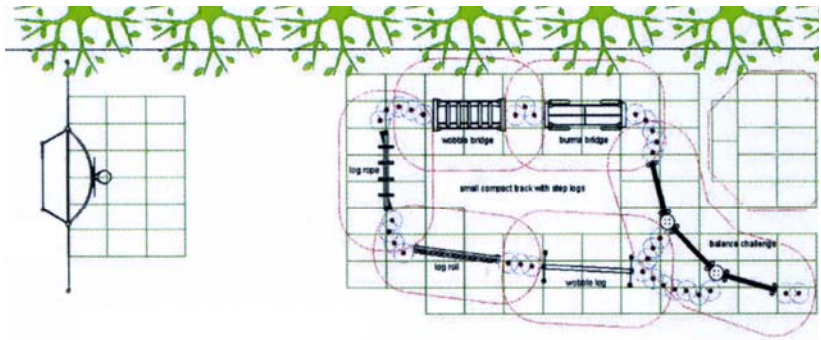

**PLAYGROUND FUND RAISING FETE -  
12 noon to**

Join us and help raise the funds we need to complete this exciting

Provisional activities include Bar-B-Q, West Wycombe Brass Band, Ice Cream and  
Face Painting, Tattoos, Bric-a-Brac, Books, Tombola, Static Disple

## E PEDESTAL PLAYING FIELD PLAYGROUND

he Pedestal Playing Field. It is hoped that this will be installed in time for the school sum-  
£40,000. We have been saving money for the project over the last two years. We have  
ed as well as having the grass cut. We will also be replacing the double gates with a  
ill take place in 2011 with the installation of the Multiplay (far right on the plan) with the

**Fete on September 11th these dates could be brought forward.**

rm mh-p (Mike Henson) - donations from other businesses will be gratefully received.

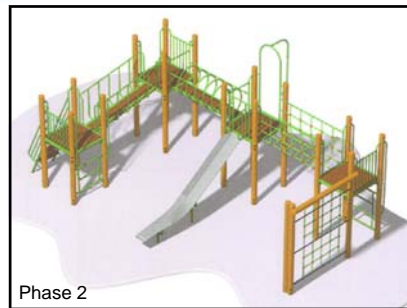
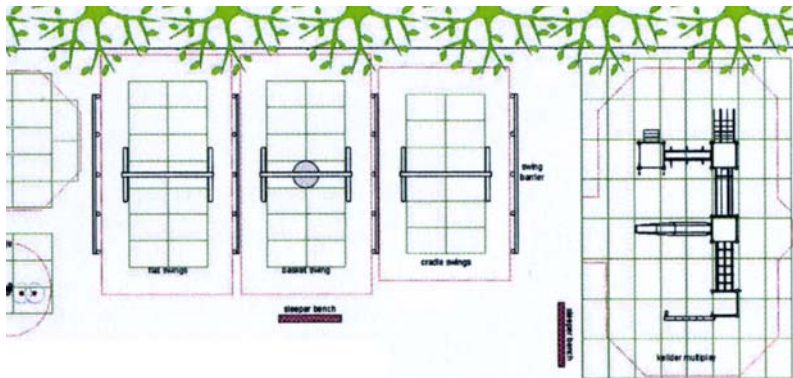

**E - SATURDAY SEPTEMBER 11th 2010**  
**1 to 4.30pm**

iting project which will benefit our children and our grand-children.

1 and Refreshments, Ferret Racing, Bouncy Castle, Coconut Shy, Vintage Lorries,  
displays, Side Stalls and of course Phase 1 of our new playground.



**VACANCY ON THE PARISH COUNCIL**

We have a vacancy for a Councillor.

Please contact the Clerk for an informal chat.

Learn more about what's involved on our website

[www.westwycombe.org.uk/roleofaparishcouncillor.html](http://www.westwycombe.org.uk/roleofaparishcouncillor.html)





### **Thank You**

We always very much appreciate everything that Sharon Henson our Clerk does for this Parish Council, without her dedication to her job and this Parish we would not have achieved Quality Status.

We are going to lose one of our councillors this coming month because Alisa Harris is moving away from West Wycombe. We would like to say thank you for the time she has given to West Wycombe Parish Council and wish her and her family many happy years in their new home.

Finally, as Chairman I would like to thank all of West Wycombe Parish Councillors for their support.

Parish Councillors are unpaid and give up a great deal of their time to try and make the area we live in a safe, comfortable and clean environment.

Our Parish Councillors and Clerk work extremely well together as a team; each one bringing their expertise and local knowledge to help us form ideas and opinions which take us forward into the future.

Whilst we all love the area in which we live we realise that we cannot let it stagnate.

We strive to keep the best and improve where we can. We hope our residents feel confident knowing that their Parish Council is one of the best in the County.

### **Park Farm Road**

The residents of Park Farm Road approached Wycombe District Council, Bucks County Council and ourselves to see if we could provide any financial support to enable them to replace the cherry trees which had been planted along both sides of the road. Over the years they had either died or been damaged by vehicles.

Residents contributed to the cost of the project, which WDC and BCC agreed to undertake and the Parish Council and Sir Edward Dashwood each donated £500.

The trees were planted just before the first snows of the winter and survived the bitterly cold weather we all experienced.

If you walk down Park Farm Road now you can see them all in blossom.

Congratulations to the residents of Park Farm Road for their hard work and proof that joint initiatives can work. (See the photograph in the centre of this report.)

---

### **STOP PRESS**

#### **Pedestal Playing Field - Equipment**

The Parish Council has just placed the order for the first phase of play equipment for The Pedestal Playing Field. It is hoped that this will be installed in time for the school summer holidays.

This is the first phase of a three year project (unless we raise vast amounts of money at the Fete) and you can find more information on the centre pages of this report and on the website.

<p><b>West Wycombe Fete September 11<sup>th</sup> 2010</b></p>
--

## The Financial Report

Receipts and Payments Account for the Year ended 31<sup>st</sup> March 2010

<b>Receipts</b>	<b>Year Ended 31.3.2009</b>	<b>Year Ended 31.3.2010</b>
Opening balance	<b>7002.81</b>	<b>16166.87</b>
Precept	35000.00	30000.00
Interest	312.27	1.16
HM Customs	1557.29	2462.96
Burials/Memorials	300.00	100.00
Refund towards telephone line	354.22	605.03
WDC refund—air quality elec	1391.66	1180.79
BCC Crossing Refund	0.00	387.18
Allotments	0.00	204.00
BCC Grant for allotments	0.00	1500.00
BCC Comm Leader Donation	0.00	260.00
BCC Community Leader	0.00	1500.00
Bank adjustment	0.05	0.00
<b>Total income</b>	<b>45918.30</b>	<b>54367.99</b>
<b>Payments</b>		
Administration	11437.46	14377.55
S137 payments	1301.01	100.00
Operational costs:		
Street Lighting & Air Quality	5053.57	6313.38
Burial ground	4191.08	3023.81
School crossing	1548.72	774.36
Training	36.35	108.00
West Wycombe Comm. Assc.	2000.00	0.00
Subs (Misc)	214.85	307.78
VAT on purchases	1748.74	2462.96
Room hire	20.00	120.00
Allotments	0.00	1121.30
Pedestal Playing Field	0.00	4303.00
Park Farm Road Trees	0.00	500.00
Printer (third of cost)	109.27	0.00
Air Ambulance Donation	100.00	0.00
Highways (cleaning/salt)	1505.38	449.29
Bradenham Road Bus Shelter	150.00	35.00
Miscellaneous	35.00	0.00
<b>Total Expenditure</b>	<b>29751.43</b>	<b>33996.43</b>

<b>Cumulative Balance</b>	<b>2009</b>	<b>2010</b>
Opening Balance	7002.81	16166.87
Income	38915.49	38201.12
	<b>45918.30</b>	<b>54367.99</b>
Expenditure	29751.43	33996.43
<b>Balance</b>	<b>16166.87</b>	<b>20371.56</b>

Balance agrees with receipts and payments account.

---

#### **Report of the Responsible Financial Officer - Year ended March 2010**

We have finished our financial year with a higher than normal balance as we are building up funds to allow for expenditure on The Pedestal Playing Field and the Playground Equipment.

The administrative costs are higher as it includes two years worth of website annual fees as last years annual fee was invoiced later than normal , it also now includes contributions to the Bucks County Council pension scheme for the Clerk.

We continued to pay for the School Crossing Patrol at the Garden Centre until the summer and then we were advised that the usage of the crossing is so high that Bucks County Council fully fund it.

The air pollution monitor, installed in the Village Hall Car Park by Wycombe District, continued to function until February 2010 and WDC refunded all the costs of the energy used.

Insurance cost £1107.72

We had to spend more money on salt/grit for the salt bin at the Garden Centre and we contributed to the cost of replanting the trees in Park Farm Road.

We have received a grant from Bucks County Council towards the cost of creating a car parking area at the allotments and donations from our District and County Councillors towards a piece of play equipment.

## **Your Councillors for 2010/2011**

Cllr. Mrs Vicki Smith, 2 High Street, West Wycombe, HP14 3AE  
Tel: 01494 532239 email: chairman@westwycombe.org.uk

Cllr. Roger Seymour, 78 Chorley Road, West Wycombe, HP14 3AR  
Tel: 01494 439081 (no email address at the moment)

Cllr. Frank Downes, High Barn, Flint Hall Farm, West Wycombe, HP14 4ES  
Tel: 01494 440860 email: frankdownes@westwycombe.org.uk

Cllr Mrs Carole Dakin, 18 Copperfields, West Wycombe Road, HP12 4AN  
Tel: 01494 437670 email: caroledakin@westwycombe.org.uk

Cllr Danny Callaghan, 33 Bradenham Road, West Wycombe, HP14 4EY  
Tel: 01494 562346 email: dannycallaghan@westwycombe.org.uk

Cllr Neil Timberlake, 8 Portway Drive, West Wycombe, HP12 4AU.  
Tel: 01494 459004 email: neiltimberlake@westwycombe.org.uk

Clerk: Mrs Sharon L. Henson, 18 Portway Drive, West Wycombe, HP12 4AU  
Tel: 01494 448048 email: clerk@westwycombe.org.uk

District Cllr Mrs Jean Teesdale, 43 Green Lane, Radnage, Bucks  
Tel: 01494 483298 email: jean\_teesdale@wycombe.gov.uk

District Cllr Mr Ian McEnnis, 49 London Road, High Wycombe, HP11 1BN  
Tel: 01494 462834 email: ian\_mcennis@wycombe.gov.uk

County Cllr Mr Frank. Downes – as above

### **VACANCY ON THE PARISH COUNCIL**

We have a vacancy for a Councillor.

Please contact the Clerk for an informal chat.

Learn more about what's involved on our website

[www.westwycombe.org.uk/roleofaparishcouncillor.html](http://www.westwycombe.org.uk/roleofaparishcouncillor.html)